

ENDUOTM CARGO

by New Motion Labs

DESIGNED TO DELIVER

Built to meet the demands of eCargo bikes, Enduo Cargo combines revolutionary dual engagement sprocket technology with industrial strength chains for a drivetrain you can rely on.



Go Beyond 15,000 km

with the longest lasting eCargo chain drive



Diminish Breakdowns

with the strongest ever eCargo chain drive



Save Time & Money

with the lowest maintenance eCargo chain drive



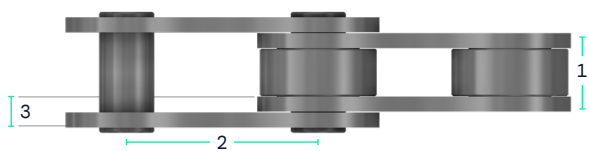

CONVENTIONAL CHAIN

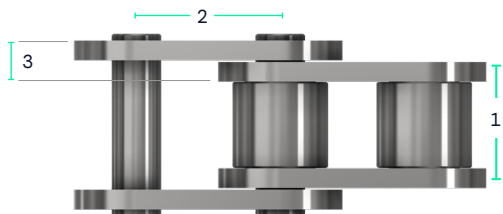

CARGO CHAIN

1. 30% Thicker Plates

Eliminating chain failure from high loads, for a drivetrain you can always rely on.

2. 60% Longer Bearing Surfaces

Sharing the load over a larger area.

3. Shorter Chain Pitch

Minimising sliding distances with smaller articulation angles

Specifically designed for Cargo ebikes, the Enduo Cargo outlasts every other chain drive, with a lifetime of more than 15,000 km.

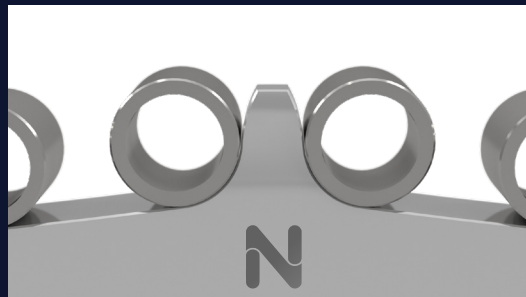

Enduo sprockets have half the number of teeth as conventional sprockets with a patented tooth geometry to ensure roller contact on both sides of the tooth. By securely engaging each tooth with two rollers, Enduo teeth relieve the stresses at the wear points within the chain, leading to a 30% longer chain lifetime.



Zinc Aluminium Coatings

Suited for all riding conditions, reducing maintenance and keeping you out of the workshop.